

PrimeLine Torktumlare T 8218 K T 9253 E/K/VP

Installationsmanual



Använd inte denna apparat förrän du har läst dessa instruktioner!
Om den här maskinen byter äger så måste den här manualen följa
med maskinen.

01/2025
Produkt Nr. MGR0.1,
MWR0.1 , MTR0.1, MQR0.1

Innehåll / Content

SVENSKA

Säkerhet och skyddsåtgärder	5
Transportera maskinen	6
Installera maskinen	7
Tvättpelare	9
Avlopp	9
Anslutningsmöjligheter	10
Frånluftsöppningar	11
Frånluftskanal	11
Installera frånluftskanal	13
Elanslutning	15

ENGLISH

Safety and safety measures	17
Transporting the machine	18
Installing the appliance	19
Washer-Dryer tower	21
Water outlet	21
Possibilities for connection	22
Exhaust vents	23
Exhaust air duct	23
Installing the exhaust duct	25
Electrical connection	27

Symbols



Please read the instructions.



Warnings are marked with a warning triangle.

The text gives information how a dangerous situation can be avoided.

Signal words indicate the severity of the danger, if not avoided.



Warning

means that possible personal injuries, and potentially life-threatening injuries may occur.



Important

means property damages may occur.

Safety and safety measures

When installing and connecting the appliance, the following safety instructions, warnings, general instructions and any possible special regulations of the locally responsible water and electricity supply companies must be observed.

- ▶ Have the machine installed according to the mounting instructions by qualified and trained personnel.
- ▶ Check the machine for transport damage. Do not connect an appliance which displays visible damage.

Warning

Risk of injury!

The dryer is very heavy.

- ▶ When transporting or installing the machine (unloading, moving etc.), make sure that it does not fall down or tips over.

Components sticking out from the machine (e.g. loading door, cover plate) may break off and cause injuries, when used for lifting.

- ▶ Do not grip the appliance on components sticking out.

Inexpert installation of hoses and power cables may cause trip hazards and danger of injury.

- ▶ Lay hoses and cables in such a way that they do not represent a risk of tripping.

When playing with packaging material / film and packaging parts, children may become entrapped in it or pull these over their head and suffocate.

- ▶ Keep packaging material away from children.

Warning

Danger of electric shock!

There is a risk of short circuits and fire, when operating the dryer outdoors.

- ▶ The machine must not be operated outdoors (e.g. balcony).
- ▶ Make certain that the temperature does not fall below the minimum temperature of 5 °C at the appliance site. Otherwise, error message «Error F – 11» might be displayed.
- ▶ Do not install the machine behind a lockable door, a sliding door or a door with a hinge that faces the hinge of the dryer door in such a way that the loading door of the dryer cannot be completely opened.

- ▶ The ventilation openings in the housing floor must not be obstructed by carpeting.
- ▶ Operating temperature of the appliance is 5 to 35 °C.

Warning

Risk of fire!

Risk of poisoning!

Damage to goods and equipment!

The device contains the environmentally friendly, but flammable refrigerant R290.

- ▶ Always ensure that the air vent on the dryer remains unobstructed.
- ▶ Ensure adequate ventilation in the room.
- ▶ Keep open flames and sources of ignition away from the device.

Transporting the machine

Important

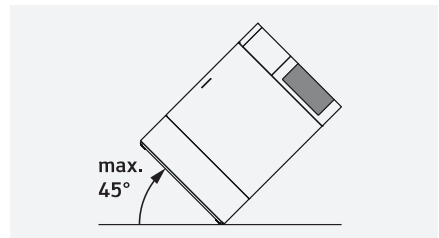

Maximum tilt of the machine to the right: 45°.

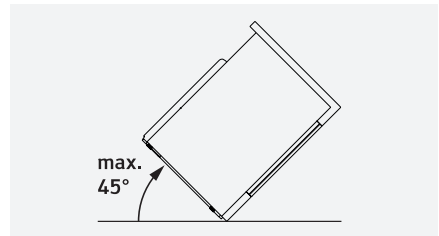

Maximum tilt of the machine to the front: 45°

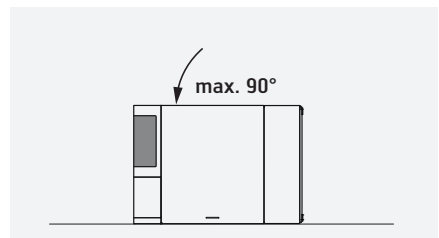

The machine may be carefully laid onto the left side:

After each transport, the appliance must be left idle for 10 minutes before it may be switched on.

Installing the appliance

Notice

Do not install the dryer in an enclosed area or in any area without fresh air circulation.

Insufficient room ventilation may prolong the drying time and increase the energy consumption.

- ▶ The dryer must be installed in a room that is adequately ventilated.
- ▶ During the drying process take care to ensure that the room is well ventilated (open windows or the door, unclosable ventilation openings in the walls or doors).

Installation area

In order to ensure the stability of the appliance, the installation area must be firm and level.

Soft floor coverings, e.g. fitted carpets or coverings with a foamed material backing are not suitable as an installation area.

Do not obstruct the ventilation grille at the bottom of the front of the appliance, otherwise sufficient flow of cooling air cannot be guaranteed.

- ▶ Keep the area surrounding the dryer free of dust and fluff.

Fixing set

For installation on slippery ground, e.g. installation base with tile surface, two self-adhesive receptacles secure the machine from shifting.

You can purchase the following fixing sets at your specialist retailer or through our customer services team:

- ▶ Steel fixing set – to be drilled

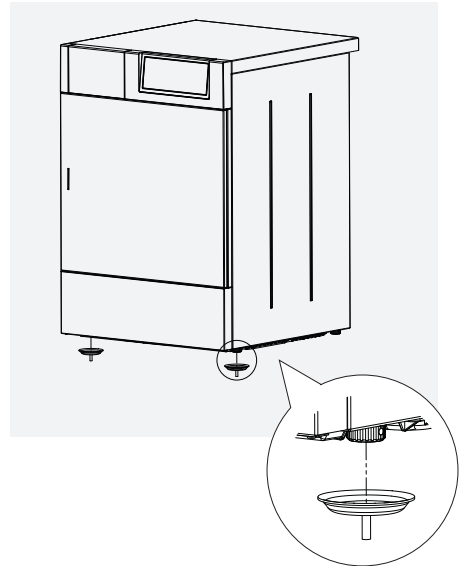

- ▶ Plastic fixing set – to be glued

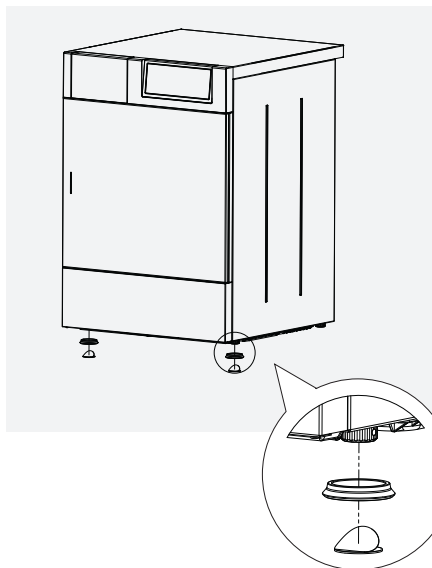

⚠ Important

The machine must be placed with its back against a wall.

Aligning the appliance

- ▶ Align the appliance with the help of a spirit level. Otherwise, the machine may wander and cause damage or lose condensation water.
-

Notice

The machine must be in a vertical position with all four feet firmly on the floor and it must not wobble.

Keep machine dimensions in mind

The minimum distance between the machine and the wall or possibly another machine is 1 cm.

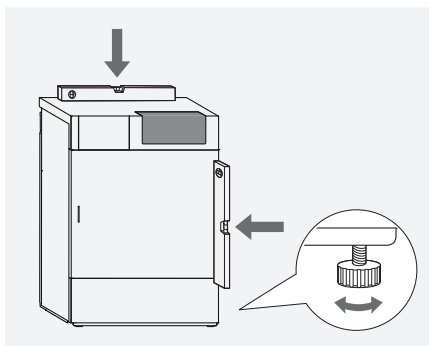
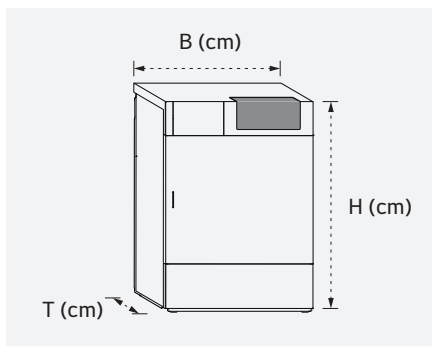

EFH:

B = 60 / H = 85 / T = 64

MFH:

B = 63 / H = 90 / T = 84

Washer-Dryer tower

In order to save space (installation space), you can place your dryer on top of a washing machine (washer-dryer tower). It is absolutely imperative not to mount a washing machine on a dryer, risk of falling.

You can obtain the appropriate parts as a construction kit from your specialist dealer or our customer service. The installation must be carried out by a specialised electrician.

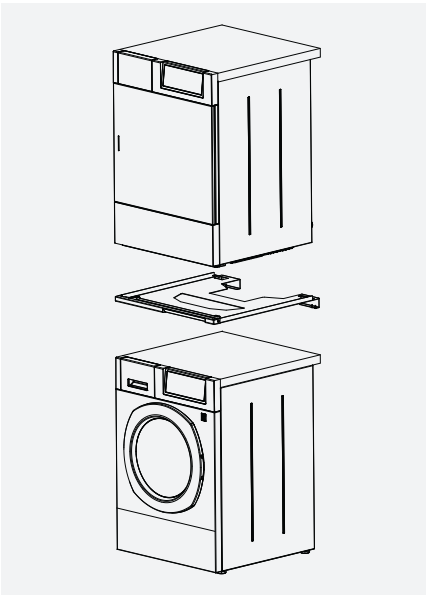

Warning

Risk of tipping!

- ▶ It is absolutely imperative not to mount a washing machine on a dryer.
-

Water outlet

only applies to heat pump dryer and condensing dryer

The condensed water collects in the condensate pan and is pumped into the drain pipe from there.

The drainage hose is fastened to the condensate pan on the back of the dryer and may be directed to the left or to the right.

Dimensions condensate drain hose:
ø 10 / 15 x 1900 mm

- ▶ The waste water hose may be conducted in the siphon of a sink unit or another waste pipe.

Important

Check that there is no tension on the drainage hose.

Strong tension may kink the hose, which prevents the condensation water from being pumped out.

- ▶ Ensure that the pump must not pump higher than 100 cm and that no waste water can run back into the condensation pan.
-

If the distance to the drain at the customer's is too big, you can obtain an extension set from your specialist dealer or customer service:

Possibilities for connection

Introduction of the condensate hose into a standpipe with siphon

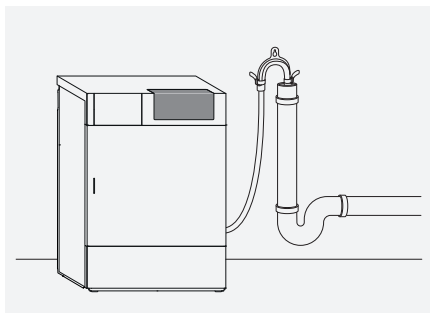

Route drainage hose into shared siphon

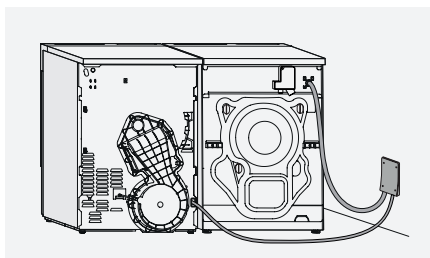

- ▶ Machines are set up next to each other

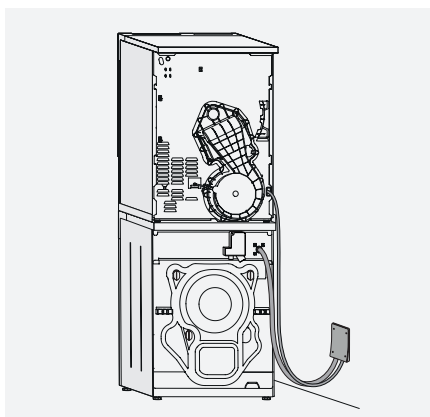

- ▶ Washer-dryer tower
When using the same siphon for the washing machine and the dryer, it might become necessary to install a check valve on the back wall of the dryer.

You can obtain non-return valves from your specialist dealer or our customer service.

Further possibilities

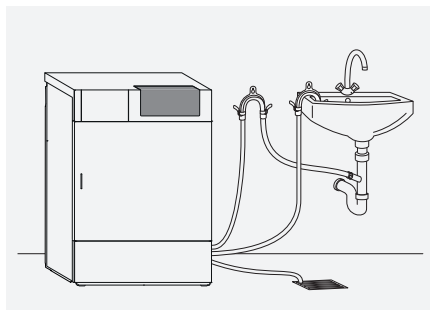

- ▶ Inserted hose elbow in a sink
- ▶ Direct connection on the siphon of a sink unit
- ▶ Introduced hose in a floor drain.

Depending on the set-up, it might be necessary to install a check valve on the back wall of the dryer.

You can obtain non-return valves from your specialist dealer or our customer service.

Exhaust vents

only applies to exhaust-air dryer

The connection possibilities for an exhaust air duct are located at the rear panel and on both sides of the appliance.

When delivered, the two lateral exhaust openings are covered.

Lateral connection variant

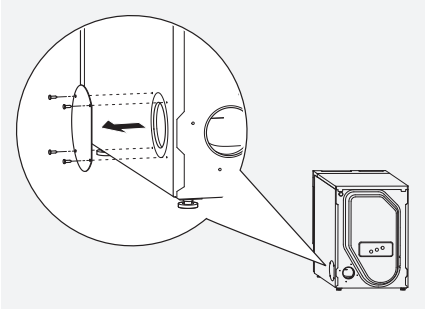

- ▶ Remove the cover of the desired exhaust opening.

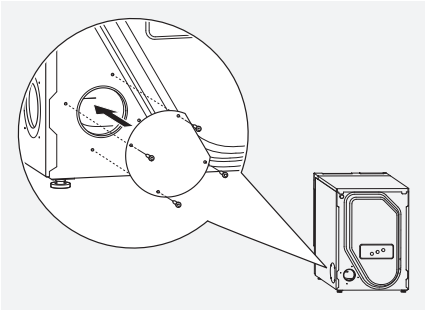

- ▶ Close the exhaust opening at the back of the dryer with the cap removed earlier.

Connecting the tube curve

Included is a tube curve with a separate sealing ring, clamping ring and four screws.

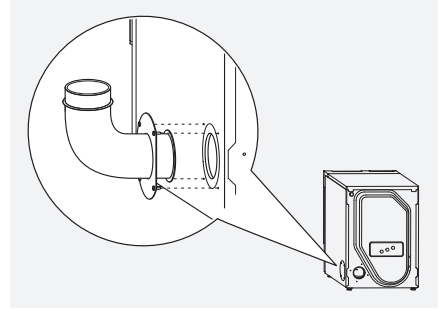

- ▶ Glue the sealing ring to the flange of the tube curve.
- ▶ Place the clamping ring over the tube curve.
- ▶ Fasten the clamping ring and tube curve with four screws to the exhaust opening.

Exhaust air duct

For the exhaust air duct you can use all normal proprietary products, such as:

- Plastic tubes
- Flexible ducts or tubes
- Galvanised metal ducts or tubes
- Connecting, transition or deflection pieces for flat duct and tube systems
- Wall boxes for exhausting into the open air or into a ventilation shaft.

Notice

- ▶ The material must be moisture-resistant and thermally stable up to 80 °C.
-

Pressure loss

The nature and length of the exhaust air duct, in particular knee pieces or curves with small radii, impede the flow of air.

- ▶ Be sure to obstruct the air flow as little as possible and keep pressure loss (resistance) minimal.

Pressure losses through friction

The air is affected by friction on the inside of the tubes and, depending on the material used, is obstructed to a greater or lesser extent.

- ▶ Use tubes with a large inner diameter, smooth inner surface and the shortest possible overall length to ensure low frictional resistance.

Pressure loss through obstacles

Additional fittings, such as curves, bends, elbows and wall boxes with grids or backpressure flaps increase the resistance.

Notice

To obtain optimal performance of the dryer when installing the exhaust line, observe the following points

- shortest possible overall length
 - largest possible inner diameter
 - avoid bends and elbows
-

Calculating the pressure loss

Notice

To ensure the minimum required air flow, the total pressure loss must not exceed the value of 150.

The table below contains the individual values for pressure loss in straight stretches, with elbows and wall boxes. The total pressure loss is derived from the sum of the respective values (for calculating the pressure loss, see examples on the opposite page).

Corrugated tubing

If the dryer can not be connected to a permanently installed exhaust air duct, there is the possibility of discharging the exhaust air through a corrugated hose.

Internal diameter > 100 mm

If a total loss of more than 150 is calculated when planning a connection with a pipe inner diameter of 100 mm, the minimum required air throughput can be achieved by increasing the inner diameter of the tube.

Installing the exhaust duct

Depending on the structural situation, the exhaust air can be conducted in different ways to the outside:

- through a wall box into the open
- through a window into the open
- through a wall box into a fireplace or ventilation shaft

Routing exhaust air through a window into the open

If there is a window at the place of installation, the exhaust air can be led directly into the open air through an exhaust air hose through the open window.

- ▶ Lay the exhaust air pipe in such a way that the dryer cannot suck the moist warm air already blown out back in again.
- ▶ The outlet opening for the exhaust air must be designed or laid in such a manner that no additional counter pressure (e.g. through direct inflow of wind) can be incurred by the waste air streaming out.

Routing the exhaust air through a wall box into a fireplace or ventilation shaft

In the case of a connection to a ventilation shaft insulated against moisture, the responsible chimney sweep is to be informed and the approval of the local building department or the owner of the building must be obtained.

- ▶ At all events, have the safe operation confirmed by your chimney sweep.

Warning

Danger of suffocation!

If additional appliances are operated in the room where the appliance is installed or in adjoining rooms, such as gas-fired heating systems, gas-fired instantaneous water heaters, coal-fired ovens with a chimney connection or open fireplaces, a partial vacuum may be caused leading to the sucking back of the exhaust gases.

- ▶ Do not route the exhaust pipe into a fireplace that is connected to devices such as gas or coal fired stoves and ovens, or gas room heaters.
-

Condensation discharge

At the lowest point in the exhaust air duct, you are recommended to fit a «condensation water collector» (proprietary) or a condensation discharge hole of about $\varnothing = 3 \text{ mm}$.

Individual values for determining the total pressure loss (max. 150)

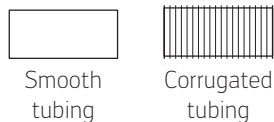

		Smooth tubing	Corrugated tubing
Straight piece	each 1m long	2	10
Tube curve	Bending radius R = 100mm	6	12
	Bending radius R = 200mm	8	15
Telescope wall box with grid		20	20

Calculating the pressure loss of the exhaust air duct

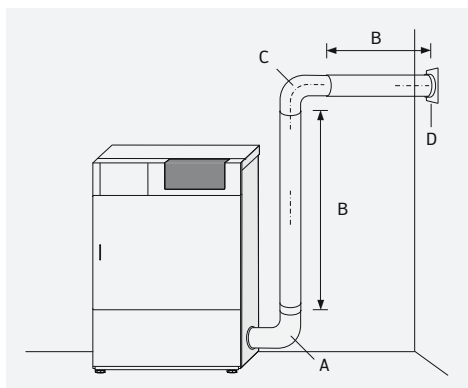

Smooth tubing

Internal diameter $\varnothing = 100$ mm

A		8
B	Tube curve	6
C	Straight pieces (total 3m)	8
D	Tube curve	
	Telescope wall box with grid	20
Total pressure loss		42

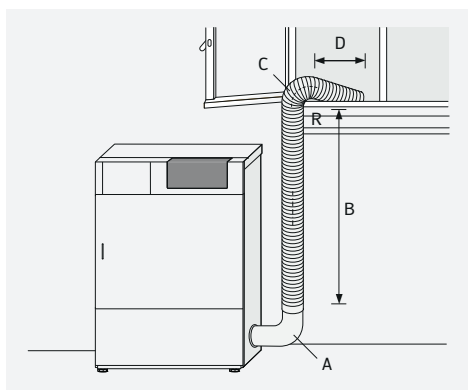

Corrugated tubing

Internal diameter $\varnothing = 100$ mm

A	Tube curve	8
B	Straight piece (1,5 m)	15
C	Tube curve (R = 100mm)	15
D	Straight piece (0,5m)	5
Total pressure loss		43

Electrical connection

Notice

Connection of the appliance to the power supply must be carried out by a specialised electrician.

When the machine is operated for the first time the **Data** and **Time** settings are to be checked and if necessary, set correctly (see **Settings / Menu Settings** in the operating instructions).

Perform the electrical connection according to the regulations or provisions made by the local electricity authority and utility companies.

In rooms in which fault-current protective switches are required or recommended in order to increase safety, the release current must be 30 mA.

- ▶ Use a fault-current protective switch with the  symbol.

Approval for fixed connection, all-pole disconnectable by a main switch with contact distance of min. 3 mm or plug contact.

Warning

Risk of electric shock and risk of fire!

- ▶ Do not use an extension cable. Avoid adaptors for multiple plugs in one socket and using multi-sockets.
 - ▶ Do not use plug-in, mobile timer switches.
 - ▶ The machine may not be connected via an external switching mechanism, which regularly switches the machine on and off (e.g. timer switch).
-

Mains cable

The appliance will be delivered with a 4-wire mains cable (length minimum: 140 cm) for connection to 2-phase alternating current with neutral conductor.

L1 brown	N blue
L2 black	PE yellow-green
L3 grey	



AB PODAB

Tel: 031-752 01 00

E-mail: salj@podab.com

Service e-mail: support@podab.com

www.podab.com



© 2025 AB PODAB

Vi förbehåller oss rätten att göra ändringar
och reserverar oss för eventuella tryckfel.

För miljöns skull trycker vi endast i mycket begrän-
sad omfattning. Du kan hitta fler dokument och
information om dina maskiner i informationsområdet
för dina maskiner på www.podab.se